

DRC

PZ23-12000017  
02/07/2024

DRC

PZ23-12000017  
09/20/2023

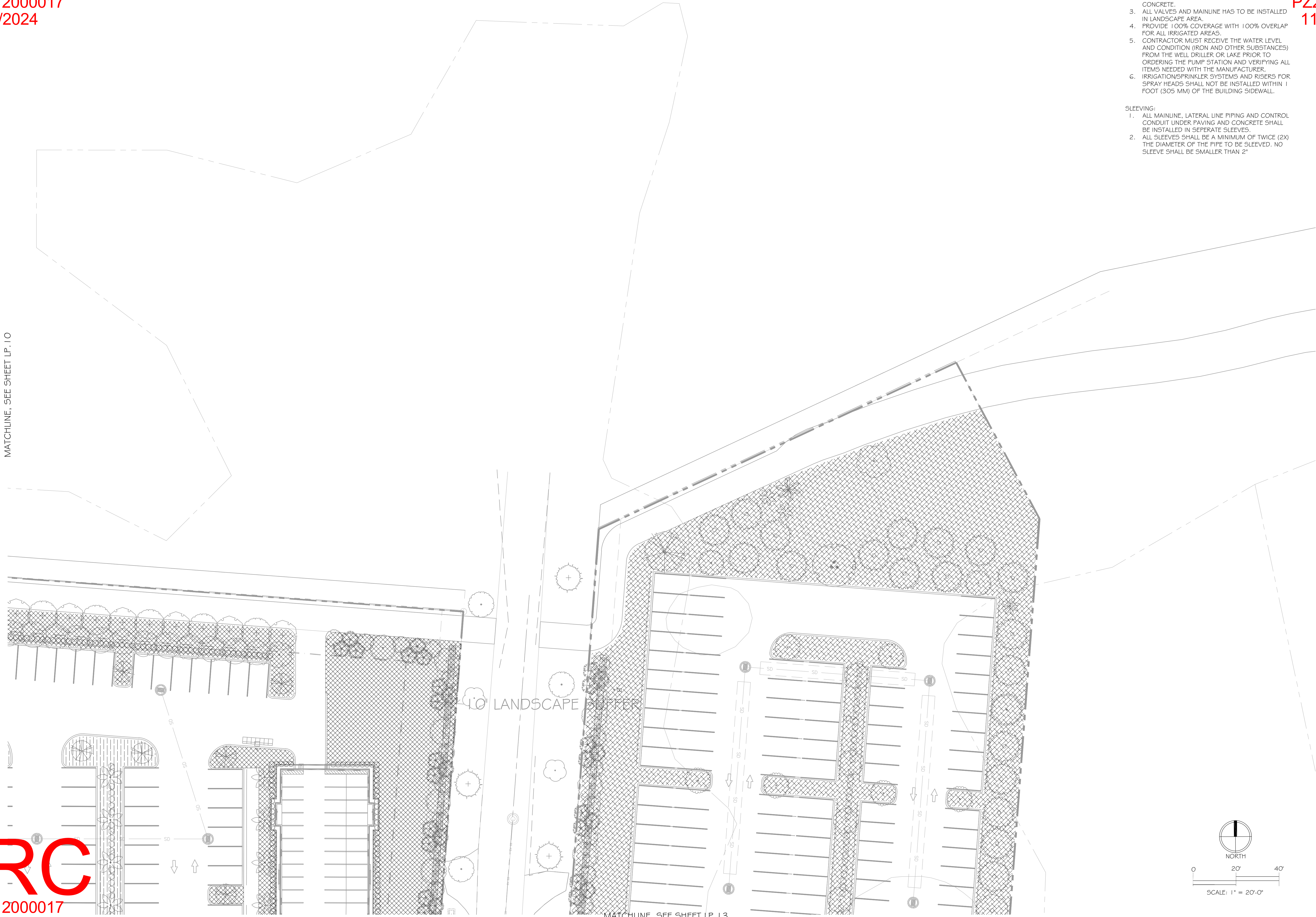

- NOTE:
1. MAIN LINE LOCATION IS SCHEMATIC ONLY.
  2. ALL CONTROL WIRE HAS TO BE IN CONDUIT IN ALL AREAS AND SLEEVED UNDER PAVING AND CONCRETE.
  3. ALL VALVES AND MAINLINE HAS TO BE INSTALLED IN LANDSCAPE AREA.
  4. PROVIDE 100% COVERAGE WITH 100% OVERLAP FOR ALL IRRIGATED AREAS.
  5. CONTRACTOR MUST RECEIVE THE WATER LEVEL AND CONDITION (IRON AND OTHER SUBSTANCES) FROM THE WELL DRILLER OR LAKE PRIOR TO ORDERING THE PUMP STATION AND VERIFYING ALL ITEMS NEEDED WITH THE MANUFACTURER.
  6. IRRIGATION/SPRINKLER SYSTEMS AND RISERS FOR SPRAY HEADS SHALL NOT BE INSTALLED WITHIN 1 FOOT (305 MM) OF THE BUILDING SIDEWALL.

- SLEEVING:
1. ALL MAINLINE, LATERAL LINE PIPING AND CONTROL CONDUIT UNDER PAVING AND CONCRETE SHALL BE INSTALLED IN SEPERATE SLEEVES.
  2. ALL SLEEVES SHALL BE A MINIMUM OF TWICE (2X) THE DIAMETER OF THE PIPE TO BE SLEEVED. NO SLEEVE SHALL BE SMALLER THAN 2"

DRC

PZ23-12000017  
11/20/2024



ins studio  
planning + landscape architecture  
3601 PGA Blvd, Suite 220, Palm Beach Gardens, FL 33410  
phone: 561-249-0940 | email: info@insstudio.com  
www.insstudio.com | License# LC26000606

Consultants:

Revisions:  
6/12/23 - Intake  
8/16/23 - 1st Resubmittal

**THE OAKS**  
Palm Aire Country Club  
Pompano Beach, Florida

**Brian Terry**  
LA 6666978  
Digitally signed by Brian Terry  
LA 6666978  
Date: 2023.08.16 12:35:38 -04'00'

ALWAYS CALL 811 TWO FULL BUSINESS DAYS BEFORE YOU DIG TO HAVE UNDERGROUND UTILITIES LOCATED AND MARKED.



Drawn By: APS/AG  
Drawing #: 1272  
File Name: LP\_1272.dwg  
Date: 04/05/2023

IRRIGATION PLAN

SHEET #: IP.11